

LEASEHOLD



Maisonette

FRIZLANDS LANE, DAGENHAM, RM10 7YD

Asking Price

£250,000

FEATURES

- ***CHAIN FREE***
- Two Double Bedrooms
- Fitted Kitchen
- Gas Central Heating
- First Floor Maisonette
- Lounge
- Shower Room
- Own Rear Garden



STEPS

Estate Agents

2 Bedroom Maisonette located in Dagenham

Steps are delighted to offer for sale this CHAIN FREE two double bedroom first floor maisonette, located with walking distance of local transport and shopping facilities on Oxlow Lane. The property comprises of a Lounge, Fitted kitchen and Shower room. With further benefits to include, Gas fired central heating, Double glazing and your own private garden.

Entrance

Via own door to lobby. Staircase to first floor landing.

Landing

Access to loft. Radiator. Two built in storage cupboards. Doors to

Lounge

16'9" x 11'8"

Two double glazed windows to front. Double radiator.

Kitchen

10'5" x 8'5"

Range of fitted wall and base units with roll top work surfaces. Stainless steel single drainer sink unit. Tiled splash backs. Wall mounted boiler. Spaces for washing machine and cooker. Built in cupboard. Double glazed window to rear.

Bedroom One

12'4" x 11'8"

Double glazed window to front. Radiator. Built in cupboard.

Bedroom Two

14'1" x 8'10" max

Double glazed to rear. Radiator. Fitted wardrobes. Built in cupboard.

Shower Room

6'3" x 5'4"

Shower cubical. Pedestal wash hand basin. Low level WC. Tiled walls. Radiator. Extractor fan. Obscure double glazed window to rear.

Exterior

54 approx

Own rear garden with brick built storage shed.

We routinely refer potential purchasers to Move with Us Ltd. It is your decision whether you choose to deal with Move with Us Ltd. In making that decision, you should know that we receive an annual payment benefits from Move with Us Ltd, equating to approximately £314.48 per referral.



DAGENHAM SALES | STEPS ESTATE AGENTS, 298 HEATHWAY, DAGENHAM, ESSEX, RM10 8LU

Call us on
020 8593 5933
dagenham@steps.me.uk
www.steps.me.uk

Council Tax Band
B

GROUND FLOOR

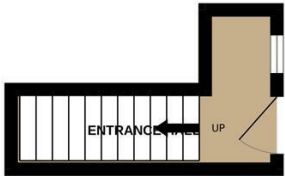

1ST FLOOR



Whilst every attempt has been made to ensure the accuracy of the floorplan contained here, measurements of doors, windows, rooms and any other items are approximate and no responsibility is taken for any error, omission or mis-statement. This plan is for illustrative purposes only and should be used as such by any prospective purchaser. The services, systems and appliances shown have not been tested and no guarantee as to their operability or efficiency can be given.
Made with Metropix ©2025

Energy Efficiency Rating		
	Current	Potential
Very energy efficient - lower running costs		
(92 plus) A		
(81-91) B		
(69-80) C		
(55-68) D		
(39-54) E		
(21-38) F		
(1-20) G		
Not energy efficient - higher running costs		
	71	77
England & Wales		
	EU Directive 2002/91/EC	

Agents Note: Whilst every care has been taken to prepare these particulars, they are for guidance purposes only. All measurements are approximate and are for general guidance purposes only and whilst every care has been taken to ensure their accuracy, they should not be relied upon and potential buyers are advised to recheck the measurements.

